

# TL Series Shaft-Mounted Reducer

## Model: TL4060

減速比 (Ratio):  
1/30~1/300

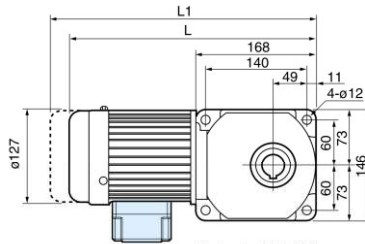
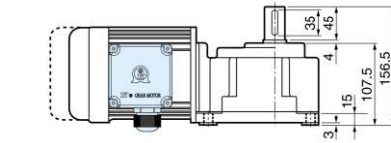

(中空軸型)

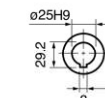

(中空軸型)

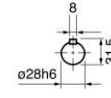

(出力軸型)(選配)

### 尺寸表 Dimension

單位: mm

馬力 (4P)	L 標準	L1 含剎車	øH	重量 (Kg)
0.1kW	328	351	127	12.0
0.2kW	345	370	127	13.0

## Model: TL4070

減速比 (Ratio):  
1/30~1/300

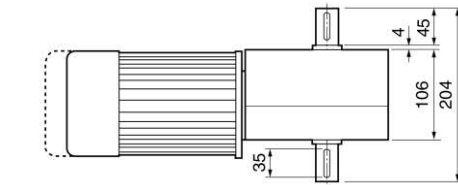

(雙出或單出力軸)

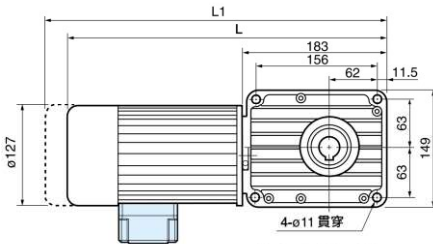

(中空軸型)

### 尺寸表 Dimension

單位: mm

馬力 (4P)	L 標準	L1 含剎車	øH	重量 (Kg)
0.2kW	363	380	127	13.5
0.4kW	382	407	127	15.5



(中空軸型)

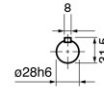

(出力軸型)(選配)

## Model: TL5080

減速比 (Ratio):  
1/30~1/300

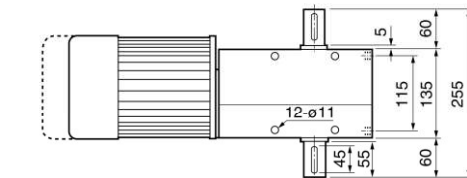

(雙出或單出力軸)

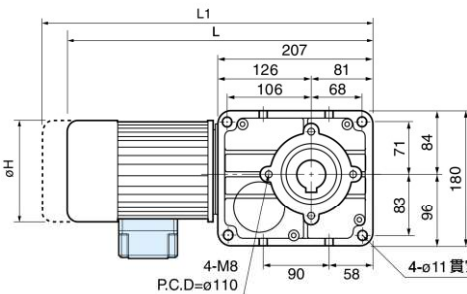

(中空軸型)

### 尺寸表 Dimension

單位: mm

馬力 (4P)	L 標準	L1 含剎車	øH	重量 (Kg)
0.75kW	433	483	160	25.2
1.5kW	465	500	192	30.5

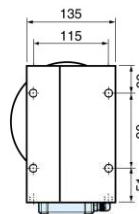

(中空軸型)

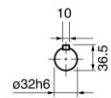

(出力軸型)

(選配)

\* L1之長度為馬達附剎車之總長。(L1 is the total length of motor with brake.)

\* 出線盒可指定向上, 向下, 左邊, 右邊。(Terminal Box position can be changed.)

\* 以上數值若有變動, 恕不另行通知\* We reserve the right to change without further notice.