

- Higher durability with urethane piston packing
- Reduced noise of compressing air with silencer
- Improved high speed charging time
- Block any debris from outside with a mesh filter
- Certified durability and reliability
- RoHS compliant

Symbol

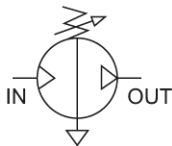

Heavy Pressure Gauge



Heavy Pressure Silencer

How to Order

ABS 100 — **10** **U** — **G40** — **10**

1
 2
 3
 4
 5

1 Bore Size

63 : 63mm
100 : 100mm

2 Set Pressure Range

10 : 1,0Mpa
16 : 1,6Mpa

3 Port Size

Blank : Rc(PT)
U : NPT

4 Pressure gauge size

Blank : None
G40 : 40mm
G27 : 27mm

※ G27 pressure gauge only for ABS63 type

5 Pressure gauge range

10 : 0 ~ 1,0 Mpa
(2 enclosures for 1,0Mpa)
20 : 0 ~ 2,5 Mpa
(1 enclosure each for 1,0Mpa and 2,5Mpa)

※ Order number for pressure gauge only
Pressure gauge (U: NPT type)

- (U)G27-10 : Ø27, 1,0Mpa
- (U)G27-25 : Ø27, 2,5Mpa
- (U)G40-10 : Ø40, 1,0Mpa
- (U)G40-25 : Ø40, 2,5Mpa

Caution) Only use pressure gauge dedicated to TPC.
Using other pressure gauge may result in product interference and/or failure

Specifications

model No.	ABS063-10	ABS100-10	ABS100-16
Fluid	Air		
Pressure Increase Ratio	Twice		
Operating Pressure Range	0,1 ~ 1,0		
Set Pressure Range	0,2 ~ 1,0	0,2 ~ 1,6	
Proof Pressure	1,5		2,4
Max. Flow	More than 1000	More than 2100	
Port size	1/2		
Gauge Port Size	1/8		
Operating Temperature Range	non freezing		
Lubrication	non-lube		
Weight	4,1	10,2	

ABS series

Structure / Part list

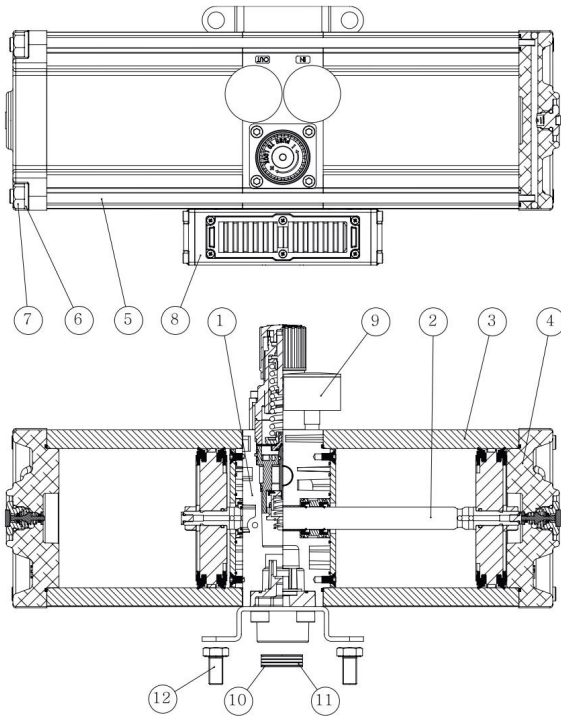

No	Parts	Materials
1	MIDDLE BODY ASS'Y	-
2	PISTON ROD ASS'Y	-
3	CLINDER TUBE AL	
4	END COVER ASS'Y -	
5	TIE ROD S20C	
6	SPRING WASHER	-
7	NUT	-
8	CONVERSION VALVE ASS'Y	-
9	PRESSURE GAUGE ASS'Y	-
10	AIR TANK NIPL AL	
11	AIR TANK NIPL O-RING	NBR
12	MOUNTING BRACKET SCREW	-

ABS 63 Dimensions

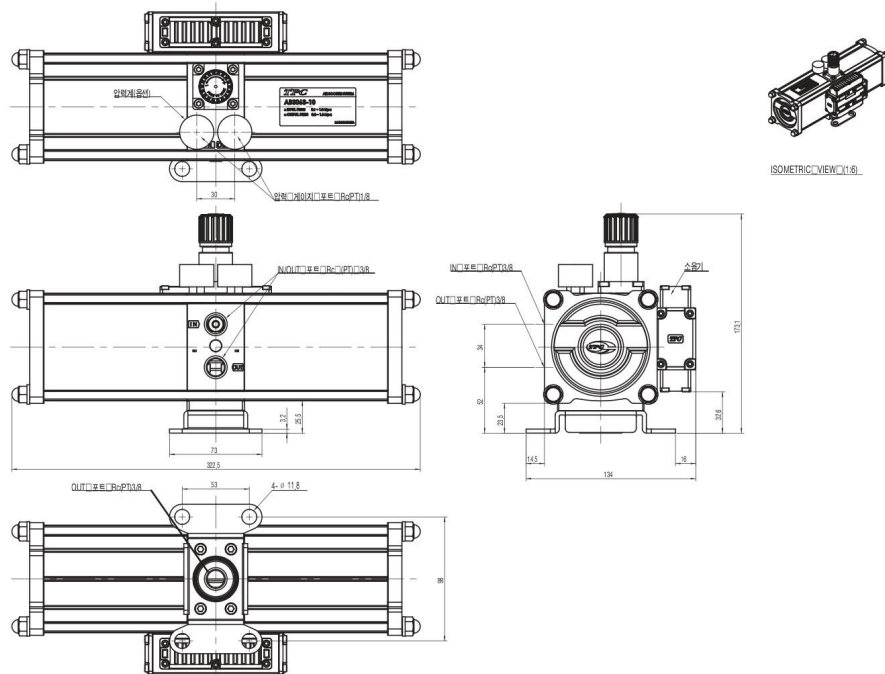

ABS 100 Dimensions

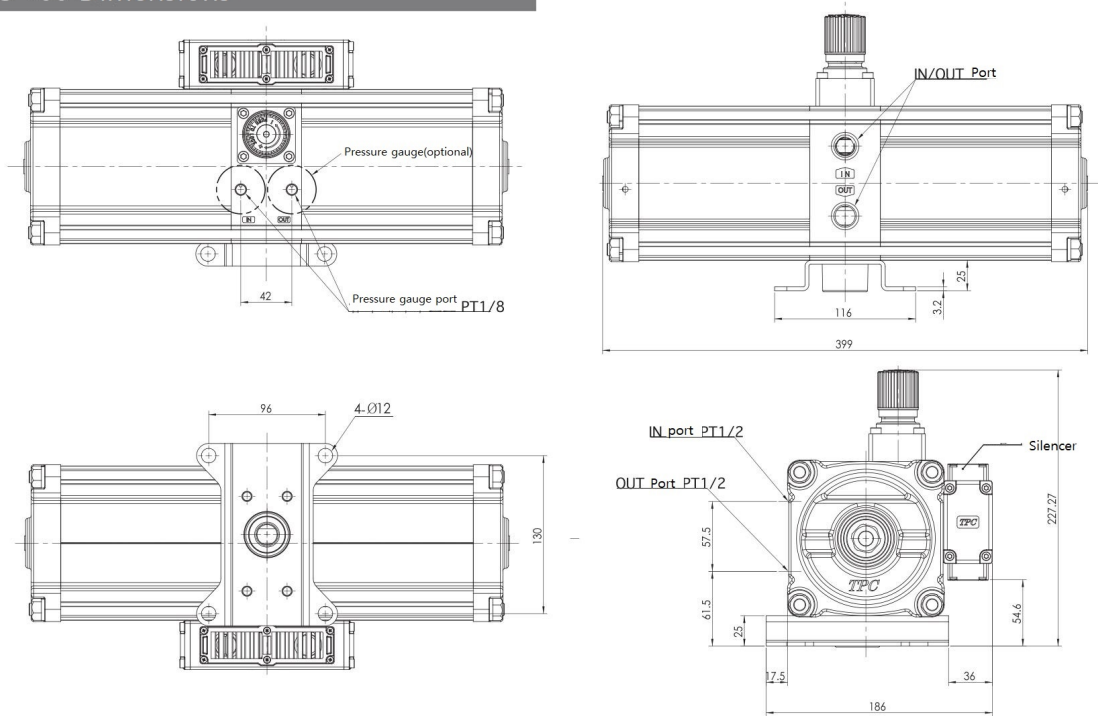

Circuit diagram and operating principal

